

HOT SPOT™ SAFETY AND OPERATING INSTRUCTIONS

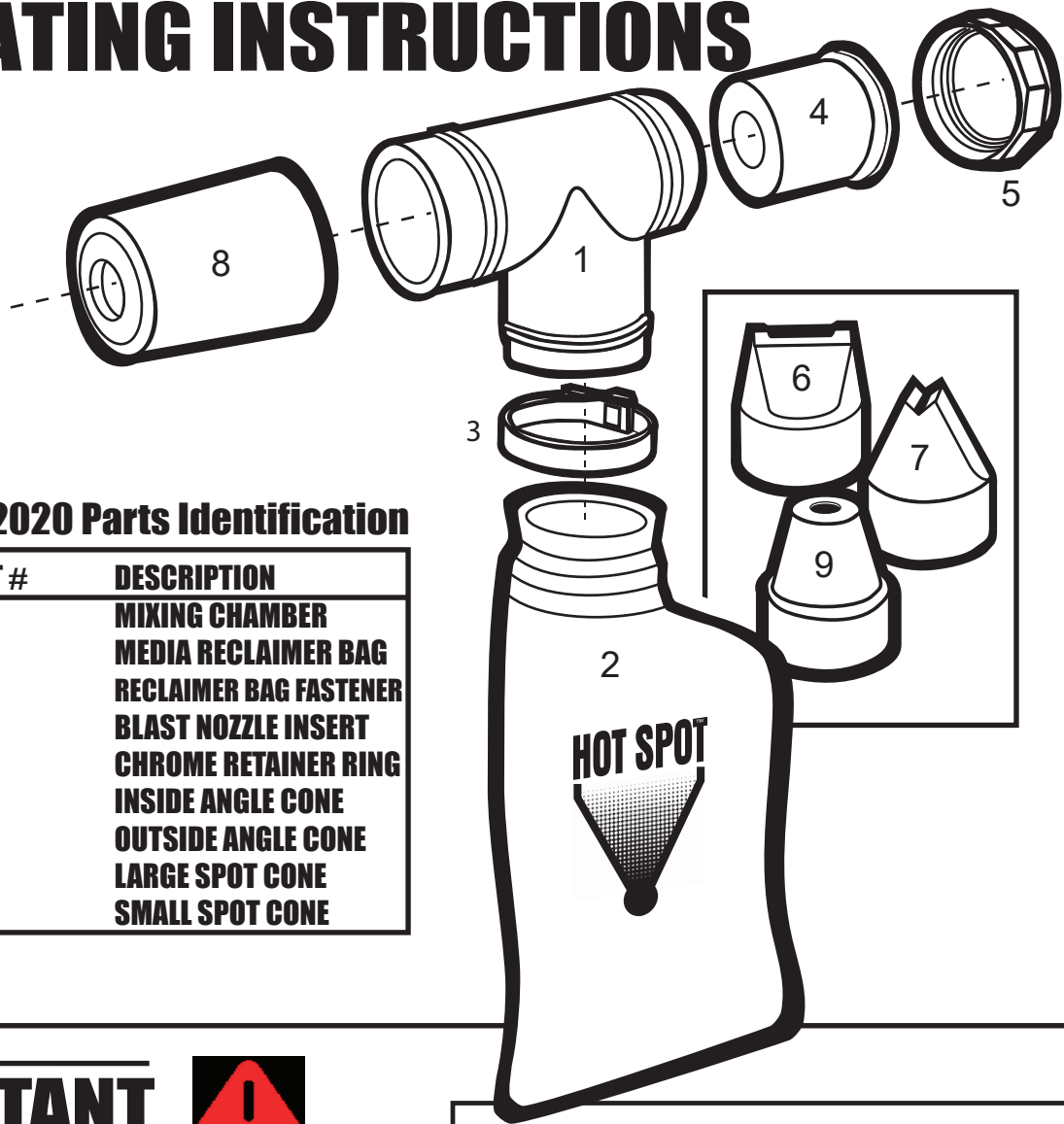

Model HS2020 Parts Identification

ITEM	PART #	DESCRIPTION
1.	HS-1	MIXING CHAMBER
2.	HS-2	MEDIA RECLAIMER BAG
3.	HS-3	RECLAIMER BAG FASTENER
4.	HS-4	BLAST NOZZLE INSERT
5.	HS-5	CHROME RETAINER RING
6.	HS-6	INSIDE ANGLE CONE
7.	HS-7	OUTSIDE ANGLE CONE
8.	HS-8	LARGE SPOT CONE
9.	HS-9	SMALL SPOT CONE

IMPORTANT



WARNING: ALWAYS wear protective clothing, eye, face and hand protection when media blasting.

WARNING: ALWAYS disconnect HotSpot™ from Speed Blaster® before installing Blast Cones. Accidentally Depressing trigger will initiate media blast spray.

WARNING: DO NOT aim media blast spray at self or at others. Particles travel at very high speed and can cause serious injury upon skin contact. Eye contact may cause blindness.

WARNING: DO NOT use HotSpot™ without Blast Cone attached.

WARNING: DO NOT use HotSpot™ unless Blast Cone is making an air tight seal to work piece to be blasted. Failure to do so will allow particles to escape uncontrollably causing possible injury.

WARNING: Replace worn or damaged Blast Cones immediately. Worn or damaged Blast Cones will not allow an air tight seal to work piece. Blast media can then escape which may cause serious injury . . . (Blast Cones are wear items and through normal use may require replacement.)

LIMITED 2-YEAR WARRANTY

The HotSpot™ accessory you have purchased is warranted to be free of defects in material and workmanship under normal use for a period of two years from the date of purchase.

Any product or component determined by Zendex Tool to be defective, due to normal use will be repaired or replaced free of charge during warranty period and returned shipping prepaid.

To Register your product Please visit
<https://zendextool.com/warranty-registration/>

To File a Warranty Claim, Please visit :
<https://zendextool.com/warranty-claim-form/>

Once a claim is submitted, you will receive an email notification with your reference number (RMA). We will then contact you within 72 hours with next steps. Please note, sending back an item without first submitting a claim may significantly delay your claims process.

4 Larson Drive • Danbury, CT 06810 •
 Phone: 1-800-446-5257
 E-Mail: support@zendextool.com
 Replacement Parts: ZendexTool.com

HOTSPOT™ INSTRUCTIONS CONT.

Only For Use With
SPEEDBLASTER®
 GRAVITY FEED MEDIA BLASTER

1. Select Blast Cone of your choice and install over front of HotSpot™ before connecting to SpeedBlaster®. Make sure cone (HS-6,7,8,9) completely bottoms out against raised ridge on mixing chamber (HS-1). Failure to do this will misalign Blast Cone to unit and shorten life of Blast Cone significantly.
 (See Illustration 1)

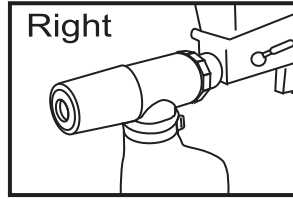
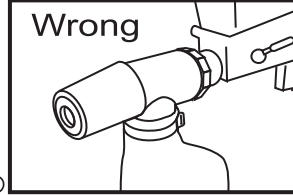

Illustration 1



2. To attach HotSpot™ to your SpeedBlaster®, push the white ceramic nozzle on the SpeedBlaster® (007-12) into blast nozzle insert (HS-4) below. Keep HotSpot™ in an upright position (twelve o'clock) and the SpeedBlaster® at nine o'clock. Applying steady pressure, push the SpeedBlaster® nozzle into the HotSpot™ and simultaneously rotate SpeedBlaster® 45° until units are square to each other
 (See illustration 2)

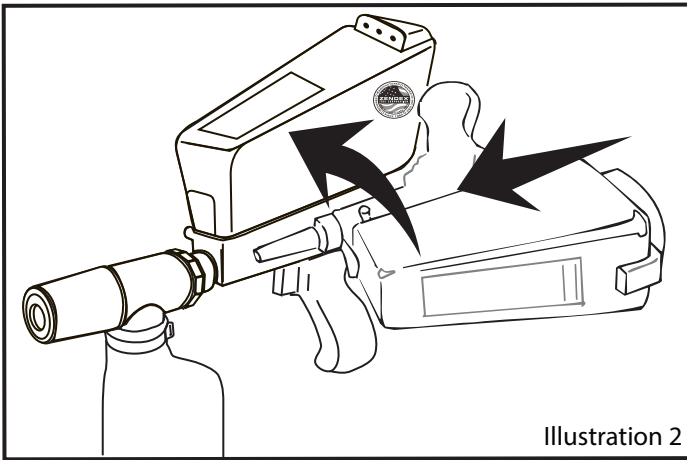

Illustration 2

NOTE: It is not necessary to force the ceramic nozzle (007-12) all the way into the rubber insert.

There should be approximately 3/16" remaining between rubber insert (HS-4) and SpeedBlaster nozzle retainer (007-13).
 (See Illustration 3)

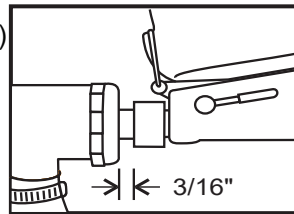

Illustration 3

NOTE: If you over turn the SpeedBlaster® and must rotate it back into alignment; make sure to re-tighten the nozzle retainer (007-13). Failure to do this may cause misalignment of the steel insert (007-14) behind the ceramic nozzle (007-12) and restrict sand flow in the Speed Blaster.

3. To spot blast; place HotSpot™ Blast Cone (HS-6,7,8,9) directly on workpiece to be blasted. Confirm there is an air tight seal. This is done by selecting the cone that best matches the contour of your workpiece and then applying steady forward pressure against area to be blasted. For best results, make sure the Blast Cone is contacting your workpiece at a 90° angle.
 (See Illustration 4a)

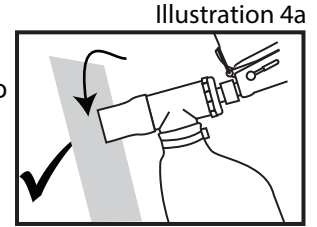

Illustration 4a

4. While spot blasting; the blast media and compressed air will be forced into the reclaimer bag (HS-2). The reclaimer bag must be emptied frequently. It is highly recommended to empty reclaimer bag once it becomes half full. Failure to do this will restrict air flow and reduce HS2020 ability to extract waste and blast media into the collection bag. This will cause premature wear
 (See Illustration 4b)

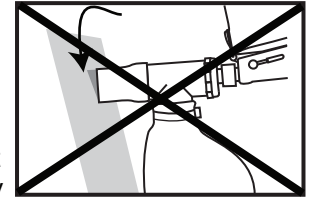

Illustration 4b

5. To disconnect HS2020; disconnect compressed air line and pull SpeedBlaster® away while rotating clockwise. This is done to keep nozzle retainer tightened at all times.

6. To empty collection bag; simply remove Blast Cone (HS-6,7,8,9) and turn unit upside down. Pour contents through the end that accepts the Blast Cone.
 (See Illustration 5)

NOTE: If you plan to recycle/reuse blast media in collection bag it is imperative to strain contents through a fine mesh screen with holes no larger than 1/16" measured diagonally. If you do not perform this step, particles larger than 14 grit will likely clog the SpeedBlaster® when reused.

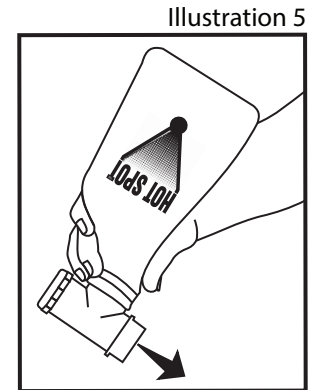

Illustration 5



-WARNING-

Shooting compressed air through gun without nozzle in place may eject steel insert. TO REMOVE INSERT SAFELY and prevent possible injury, disconnect air line and pull insert out with hook rod (SpeedBlaster® Only).



-WARNING-

Some dust created by power sanding, sawing, grinding, drilling, and other construction activities contain chemicals known to the State of California to cause cancer, birth defects, or other reproductive harm.



4 Larson Drive • Danbury, CT 06810 • U.S.A.
 Phone: 1-800-446-5257
 E-Mail: support@zendextool.com
 Replacement Parts: ZendexTool.com